

## BASETTA DI FISSAGGIO PER RIVELATORI LINEARI DI TEMPERATURA MOD.CL2

### CARATTERISTICHE GENERALI

Per l'installazione di rivelatori lineare di temperatura per applicazioni di rivelazione incendio, ad esempio cavi termosensibili digitali, cavi in fibra ottica oppure cavi analogici per la rivelazione di incendio, la Thermostick Elettrotecnica Srl ha sviluppato la clip modello CL2.

La CL2 è una clip termoplastica a doppio passaggio. La costruzione della clip provvede alla necessità di avere la possibilità di installare sino a 2 cavi in una unica clip e permettere la circolazione dell'aria intorno al cavo sensore garantendo il massimo dell'efficienza.

Molte installazioni possono essere eseguite con le clip CL2.



### ESEMPI DI UTILIZZO

Fissaggio del cavo sensore su una fune tesa

Montaggio del cavo sensore su una staffa ad "L" per la protezione di cisterne con tetto galleggiante

Installazione del cavo sensore su un oggetto il quale necessita di un specifico controllo della temperatura superficiale (es. trasformatori, cisterne di olio etc.)



### DIMENSIONI E DIMOSTRAZIONE

#### VISTA DALL'ALTO

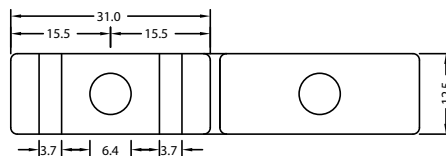

#### VISTA LATERALE

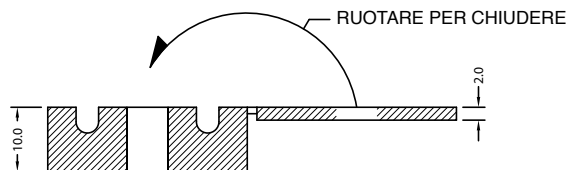

#### VISTA GENERALE

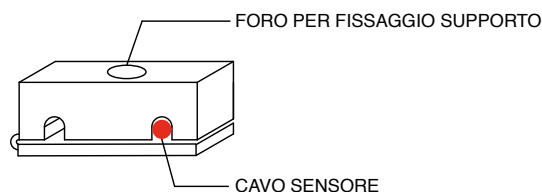

### DATI TECNICI

Materiale	Termoplastico (Polipropilene)
Colore	Blu RAL5018
Temp. di esercizio	-30°C ÷ +90°C
Supporto di fissaggio in dotazione	Vite e dado in acciaio M5

## ACA-TW11W-100 LHD CABLE ACCESSORY - TIE WRAP (PA66) 110°C (230°F) - PACK OF 100

### GENERAL

The ACA-TW series tie wraps (cable ties) is designed to secure linear heat sensor cable to the LHD brackets and clips. The tie wraps are available in various temperature ratings for matching or surpassing the temperature specifications of the selected LHD sensor cable.

UV stabilised and stainless steel variants are suitable for outdoor applications whilst stainless steel variants additionally allow for the installation of very high temperature digital cable.

A tool (ACA-TWT) is available for the stainless steel tie wrap installation.

### DETAILS

- Easy installation of linear heat cable
- For use with LHD brackets and clips
- Indoor and outdoor applications
- Available in PA66
- Available in quantities of 100

### TECHNICAL SPECIFICATIONS

#### Physical

Net weight: 15 g  
0.002 lbs

#### Environmental

Operating temperature: 110°C (230°F) In/Outdoor



## ACA-CT-100 LHD CABLE ACCESSORY - CLIP "T" - QUANTITY 100

### GENERAL

The ACA-CT "T" clip is designed to secure LHD (linear heat detection) sensor cable. It may be used as a ceiling or wall mount clip. The clip consists of a low density polyethylene resin moulding with a slot into which the heat sensing cable is located, combined with a 25 mm standoff. In ceiling applications the 25 mm standoff exposes the cable faster to any rise in temperature as it lifts the cable out of the layer of colder air that is often trapped against the ceiling.

### INSTALLATION

The clip is secured with a screw and wall plug using an M8 pan head screw self tapping screw. For extra security a tie wrap may be used to prevent the cable from being pulled from the clip. A figure-8 configuration on the tie wrap is ideal for this. Spacing for clips is recommended every meter along the length of the cable. Two clips in close proximity are used at 90 degree bends or where the cable route changes direction.

For space protection applications the ideal location for the heat sensing cable is on the ceiling or the top of the sidewall. This ensures that the cable is rapidly exposed to the plume of hot gases from any event that may arise and spread across the ceiling.

### DETAILS

- Easy installation of linear heat cable
- For ceiling or wall mount applications
- Provides insulation and spacing from walls and ceilings
- Standard M4 fixing hole
- Available in quantities of 100

### TECHNICAL SPECIFICATIONS

#### Physical

Physical dimensions: 30 x 12 x 31 mm (W x H x L)  
Net weight: 257 g 9 oz

